

Zubehör / Accessories / Accessoires

Combi-Laufschiene, Alu gelocht

Combi running track, aluminium pre-drilled
Rail de roulement, en alu perforé

Design-Blende, Alu eloxiert, zu Combi-Laufschiene

Design clip panel, aluminium anodized, for combi running track
Cache design, en alu anodisé, pour rail de roulement

Blendenendstück-Set zu 042.3004, Alu eloxiert, Deckenmontage

Panel end component set for 042.3004, aluminium anodized, ceiling mounting
Jeu d'extrémités de cache pour 042.3004, alu anodisé, montage plafond

Blendenendstück-Set zu 042.3004, Alu eloxiert, Wandmontage

Panel end component set for 042.3004, aluminium anodized, wall mounting
Jeu d'extrémités de cache pour 042.3004, alu anodisé, montage mural

Endkappen-Set zu 042.3004, Kunststoff anthrazit, Wandmontage

End cap set for 042.3004, plastic anthracite, wall mounting
Jeu d'embouts de cache pour 042.3004, plastique anthracite, montage mural

Sichtschutzdichtung, Kunststoff schwarz, in Rollen 20 m

Screening seal, plastic black, in coils
Joint pare-vue, plastique noir, en rouleaux

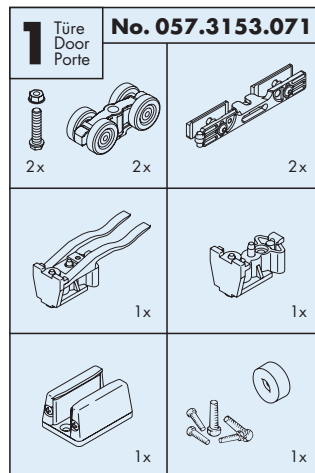

Garnituren / Sets / Garnitures

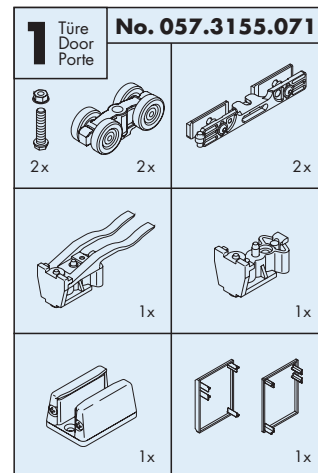

Gr./Size	Art. No.
2000 mm	057.3048.200
2500 mm	057.3048.250
3500 mm	057.3048.350
6000 mm	057.3048.600

2500 mm	042.3004.250
3500 mm	042.3004.350
6000 mm	042.3004.600

49 mm	042.3028.071
-------	--------------

44 mm	042.3028.074
-------	--------------

44 mm	057.3154.071
-------	--------------

20 m	057.3078.002
------	--------------

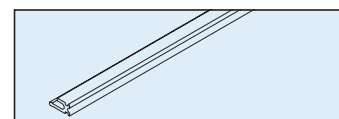
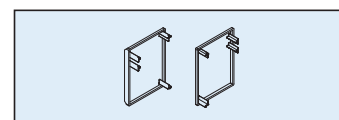
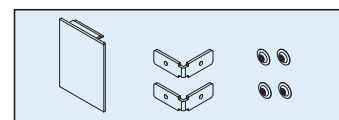
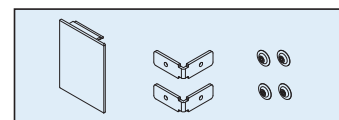
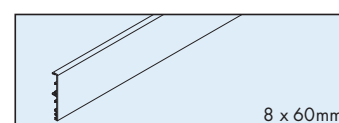
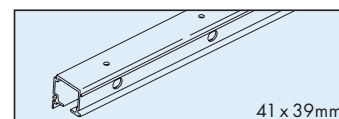
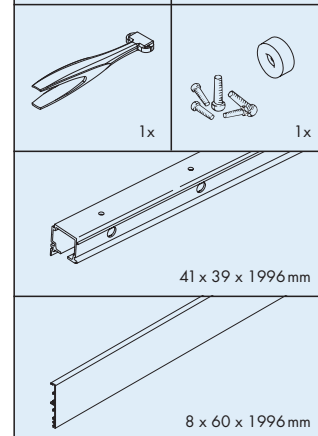

Design :



A: Blendenendstücke, Alu eloxiert
 Panel end component, aluminium anodized
 Jeu d'extrémités de cache, alu anodisé

B: Endkappen, Kunststoff anthrazit
 End cap, plastic anthracite
 Jeu d'embouts pour caches, plastique anthracite

C: Holzblende
 Wooden fascia
 Cache en bois

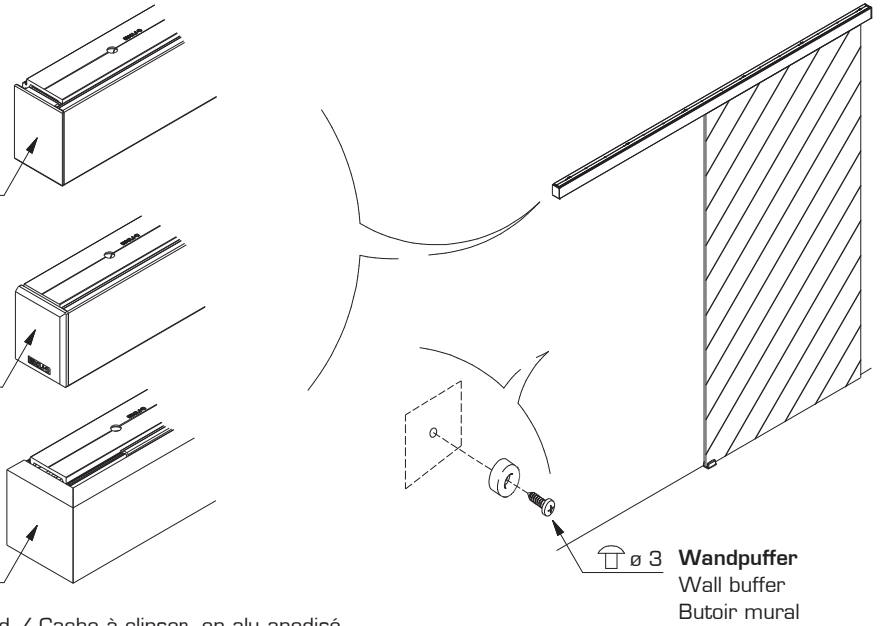

Wandpuffer
 Wall buffer
 Butoir mural

A + B: Clipblende, Alu eloxiert / Clip panel, alu anodized / Cache à clipser, en alu anodisé

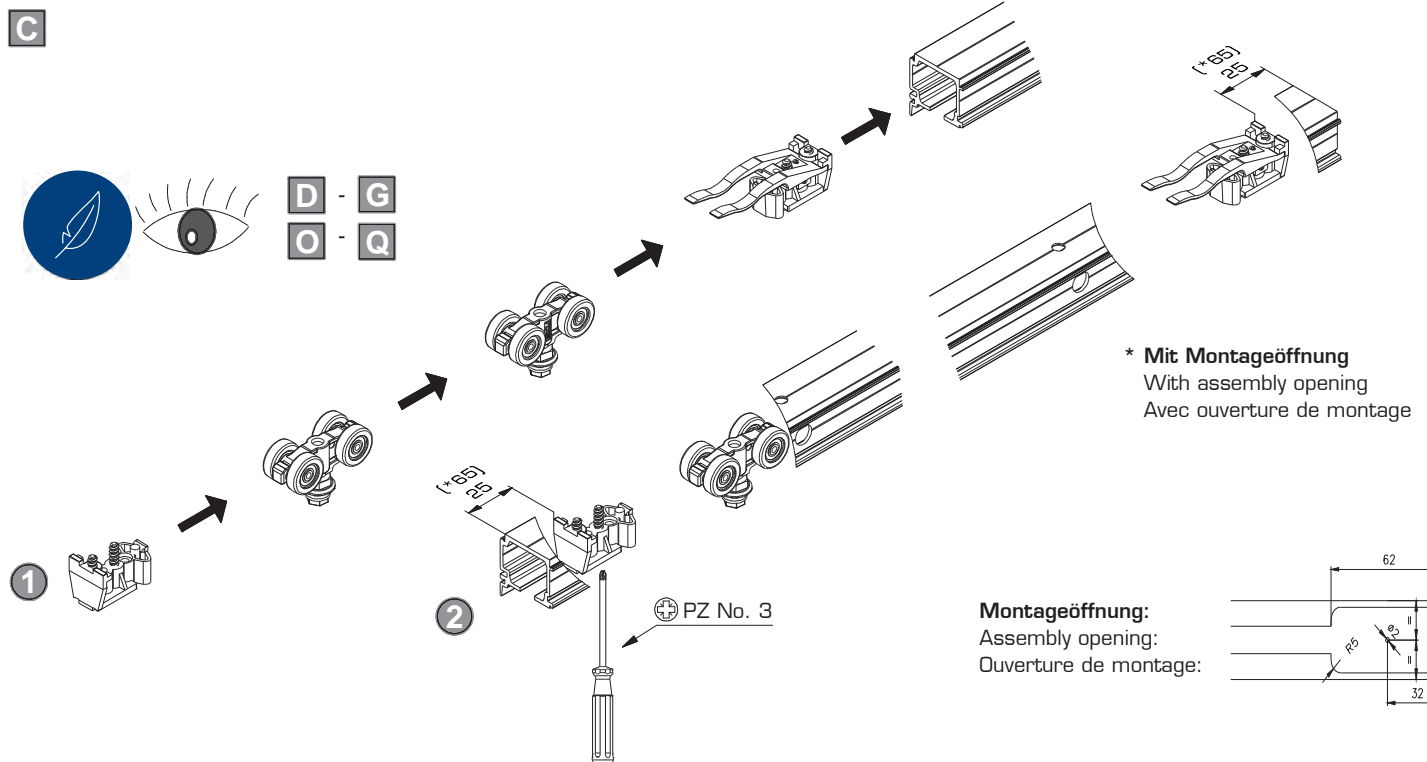
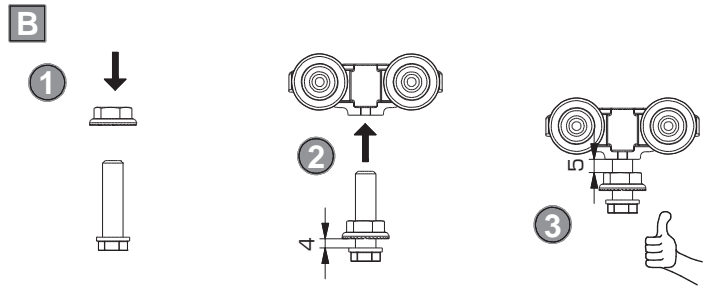
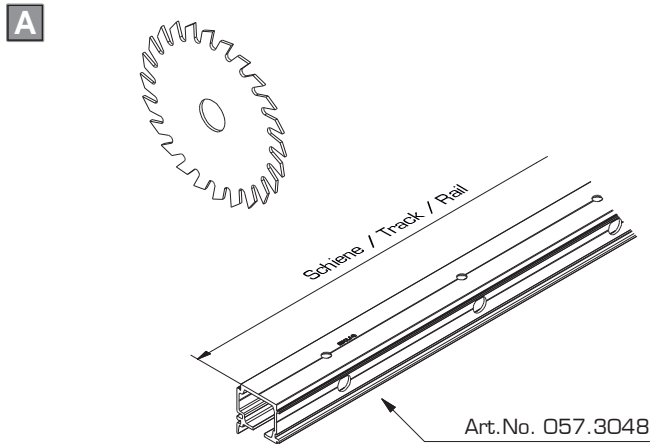



D

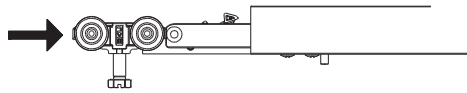

Ohne Montageöffnung
Without assembly opening
Sans ouverture de montage

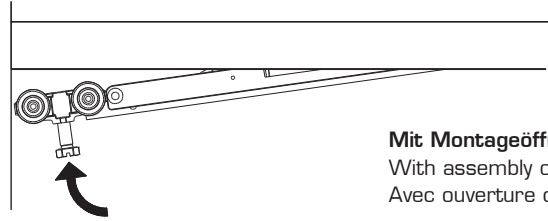

Mit Montageöffnung
With assembly opening
Avec ouverture de montage



Empfehlung Hawa: Nicht-demontierbare Laufschienen ausfräsen
Recommandation Hawa: Notch non-dismountable running tracks
Recommandation Hawa: Encoche rails de roulement non-démontable

Die Montageöffnung stellt sicher, dass die Lauftechnik und Einzugsdämpfung nachträglich eingebaut werden können, ohne dass die Laufschiene demontiert werden muss.

The assembly opening ensures that the running system and the soft and self closing system can be retrofitted without removing the running track.

L'ouverture de montage garantit la possibilité d'un montage ultérieur de la technique de roulement et de l'amortissement par traction sans devoir démonter le rail.

1

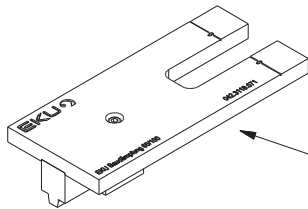

Frässhablone
Milling jig
Gabarit de fraisage
Art.No. 042.3118.071

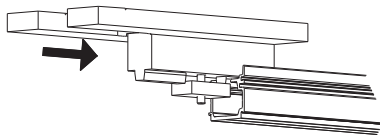

2

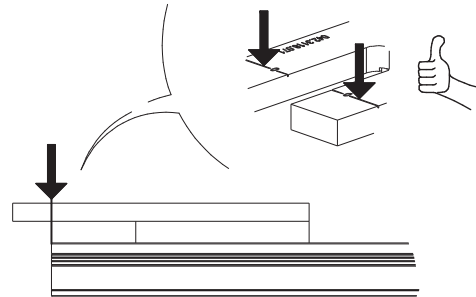

3

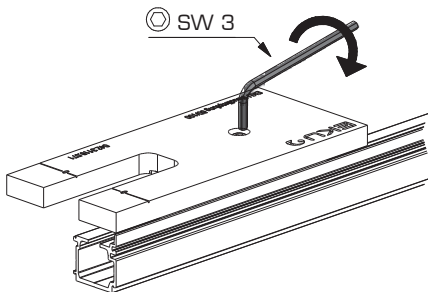

⊙ SW 3

4

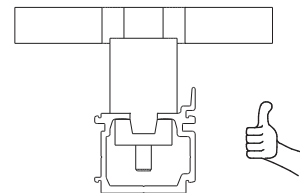

5

Nutfräser HM (Hartmetall), ø 10mm, Länge 70mm
Groove cutter HM (hard metal), ø 10mm, length 70mm
Fraise à rainurer HM (métal dur), ø 10mm, longueur 70mm
Art.No. 600.0000.309

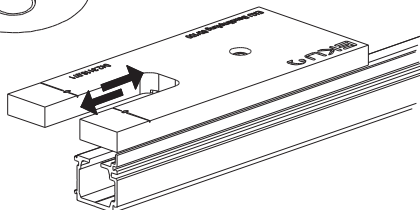
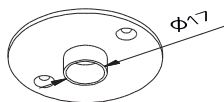
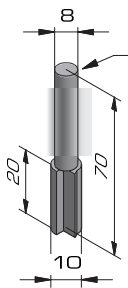

N = 8000 U/min

6

Montageöffnung:
Assembly opening:
Ouverture de montage:

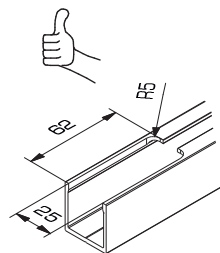

7

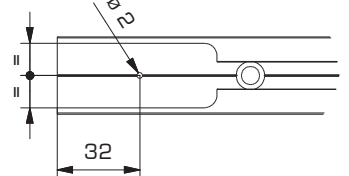

1x Dämpfen in Schliessrichtung

Soft closing function in closing direction
Amortissement dans le sens de fermeture



2x Dämpfen in Schliess- und Öffnungsrichtung

Soft closing function in opening and closing direction
Amortissement dans le sens de fermeture et d'ouverture



E

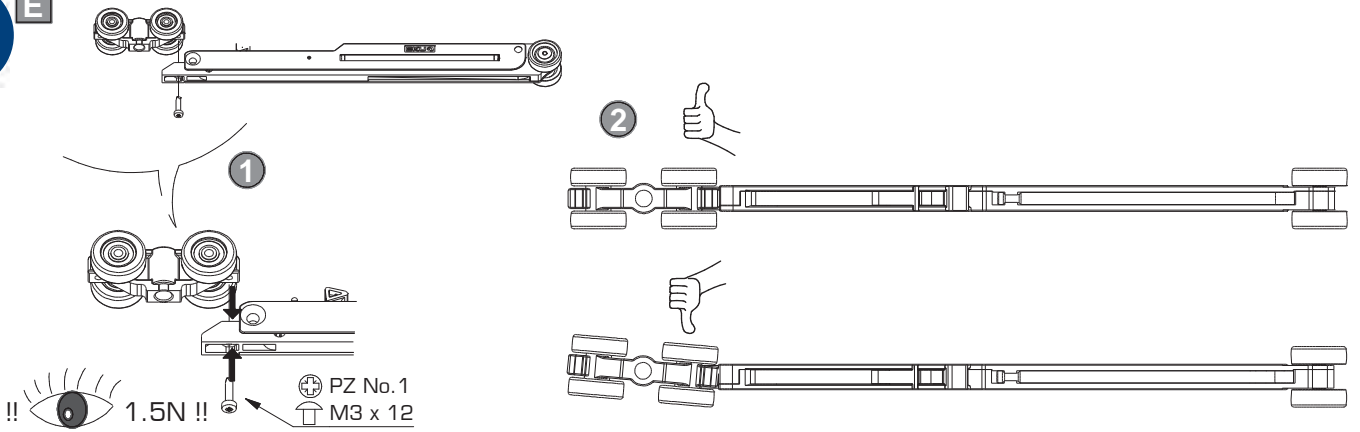

F

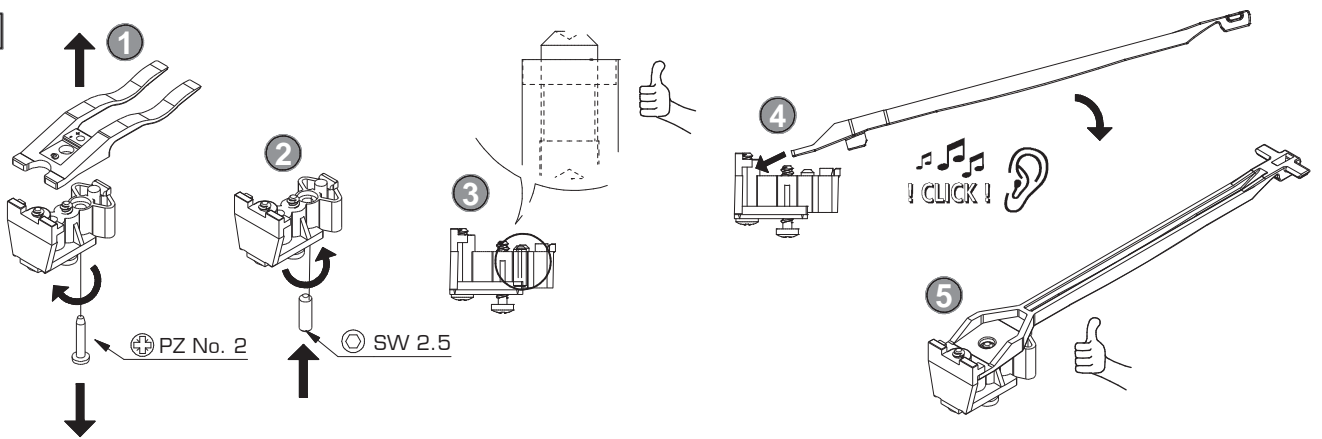

G

Dämpfen in Schliessrichtung
Soft closing function in closing direction
Amortissement dans le sens de fermeture

Dämpfen in Schliess- und Öffnungsrichtung
Soft closing function in opening and closing direction
Amortissement dans le sens de fermeture et d'ouverture

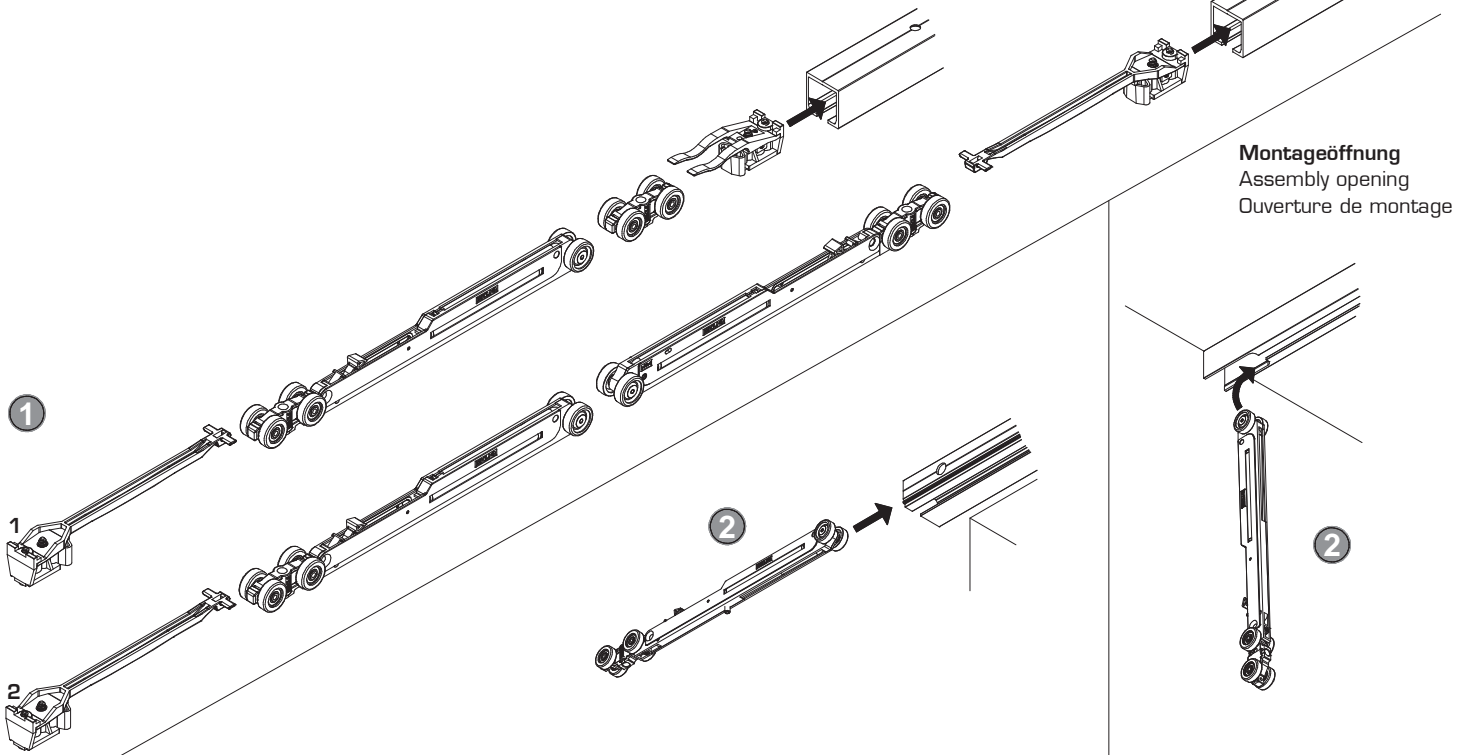
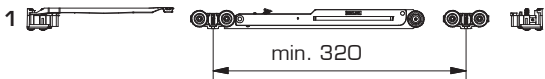

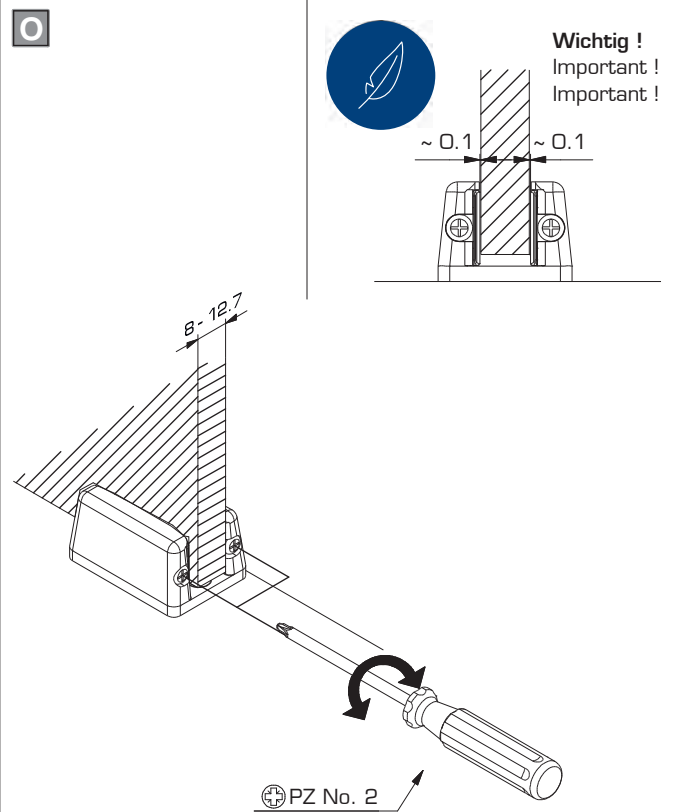
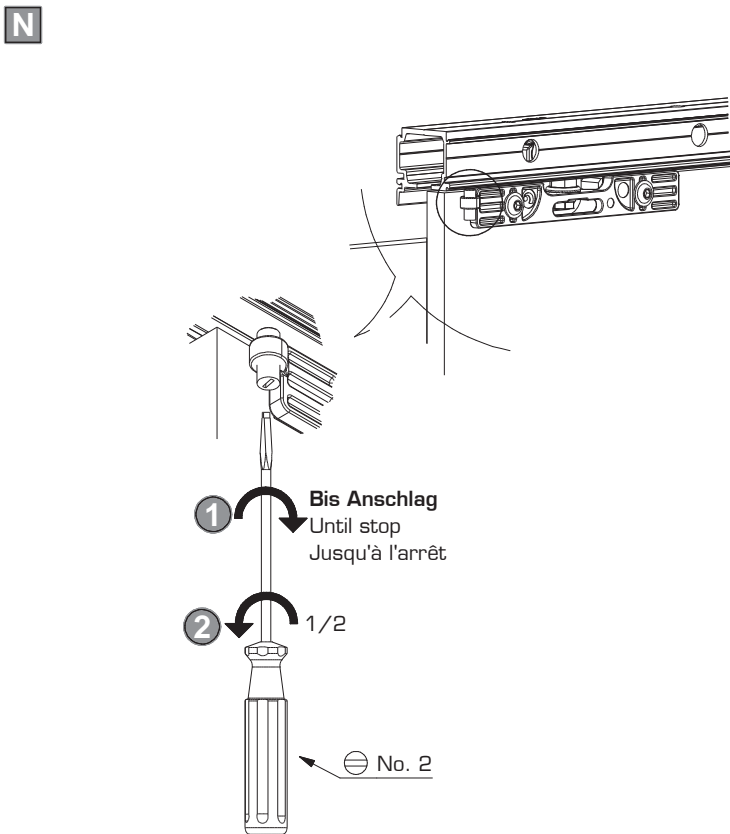
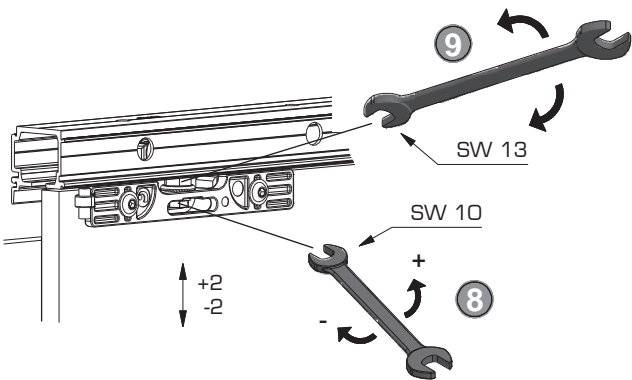
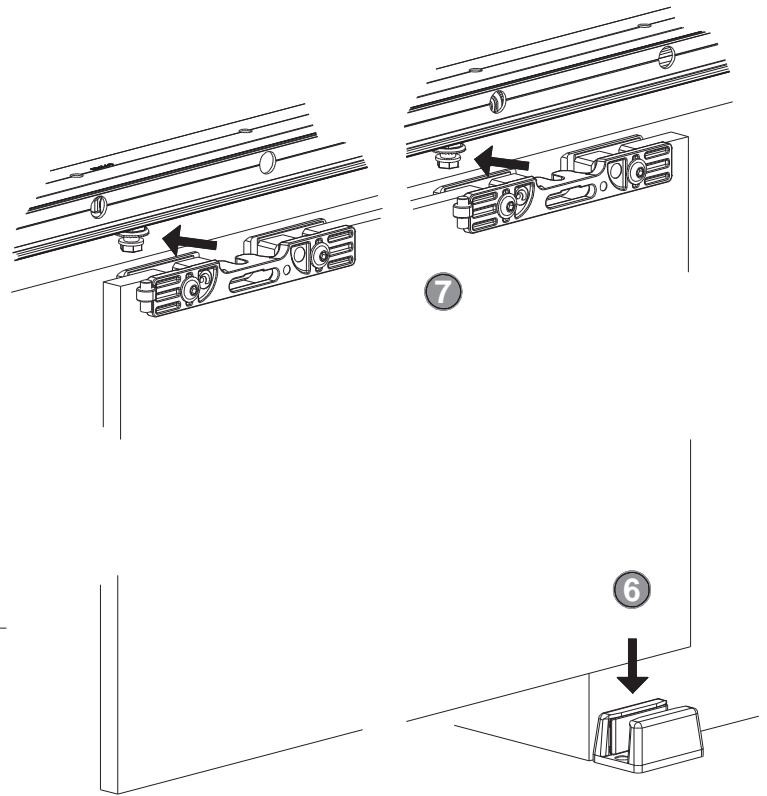
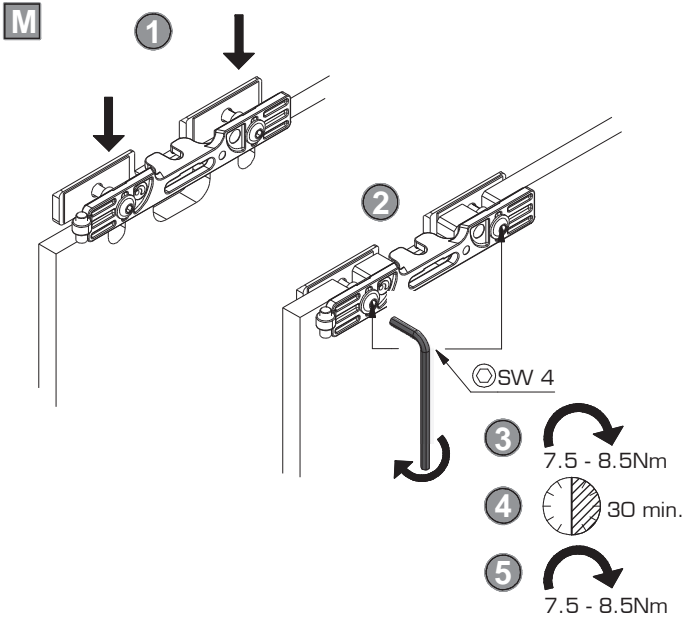



P

Montageöffnung:
 Assembly opening:
 Ouverture de montage:

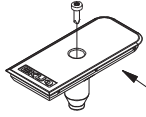

Art.No. 042.3114.071

1

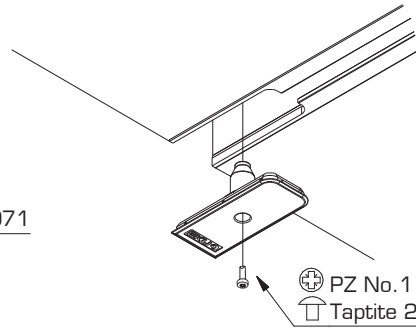

2

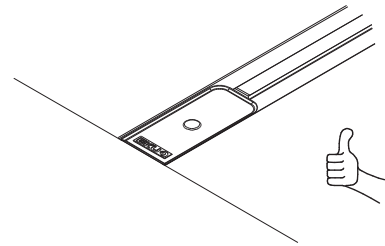

⊕ PZ No. 1
 Taptite 2.5 x 8



Q

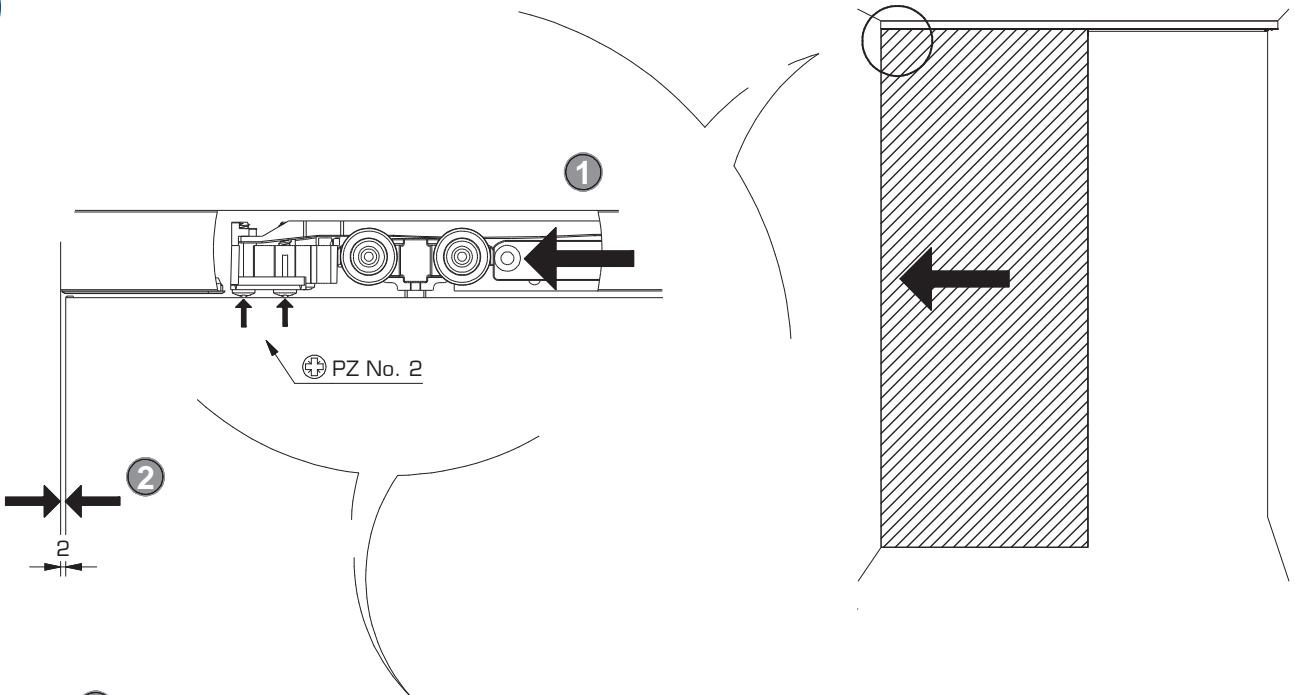

1

⊕ PZ No. 2

2

2

3

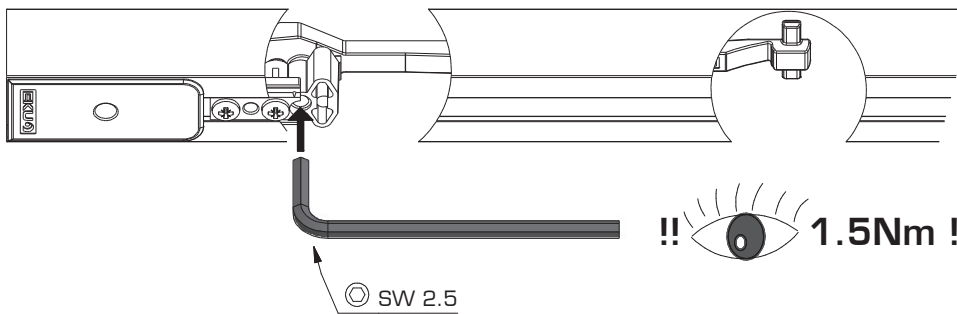

!! 1.5Nm !!

⊙ SW 2.5

4



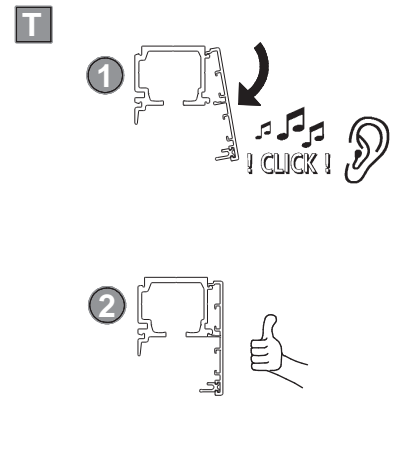
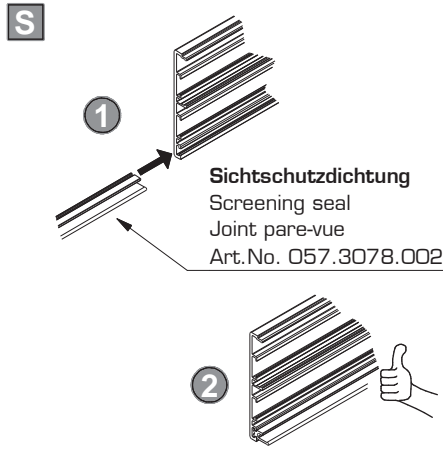
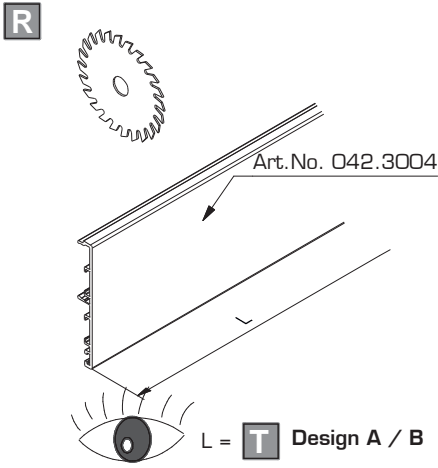

Design A:
Blendenendstücke, Alu eloxiert
Panel end component, aluminium anodized
Jeu d'extrémités de cache, alu anodisé

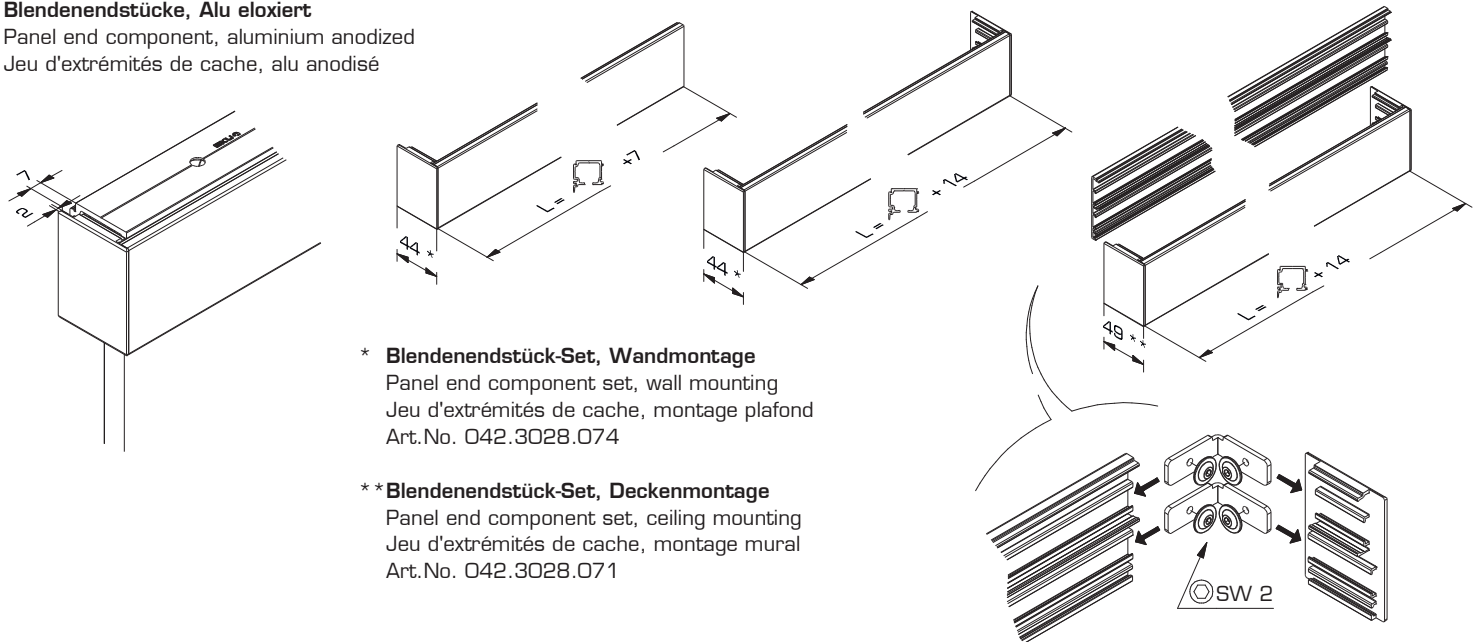

Design B:
Endkappen Kunststoff anthrazit
End cap, plastic anthracite
Jeu d'embouts pour caches, plastique anthracite

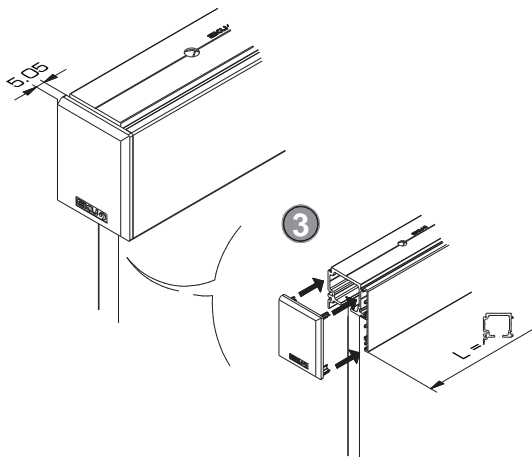

Endkappen-Set, Kunststoff anthrazit, Wandmontage
End cap set, plastic anthracite, wall mounting
Jeu d'embouts, plastique anthracite, montage mural
Art.No. 057.3154.071

T

Design C:
Holzblende
Wooden fascia
Cache en bois

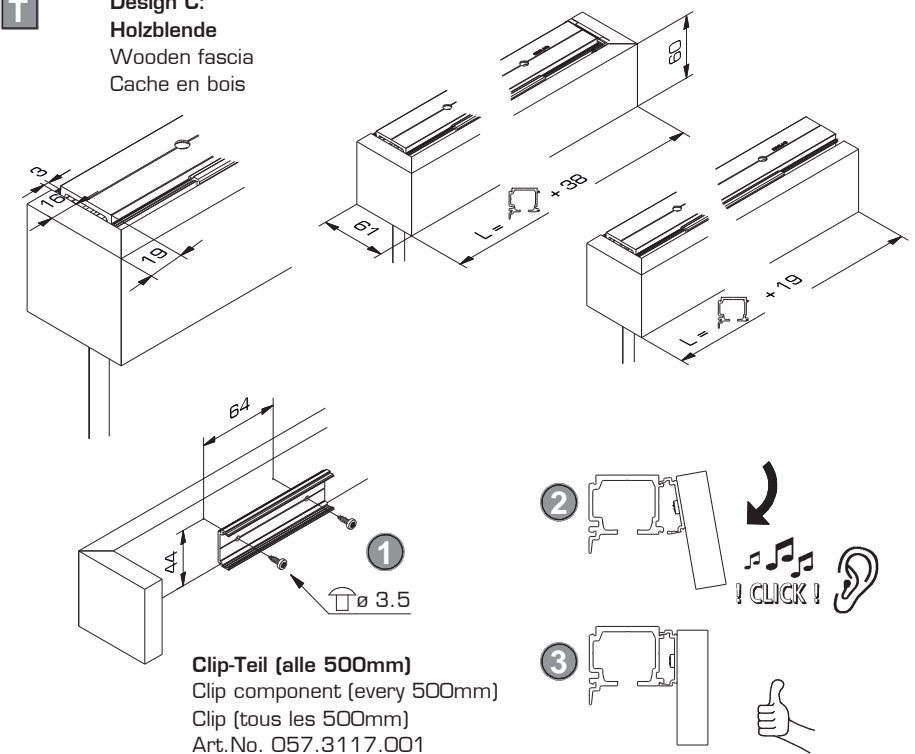

Einbaubeispiele / Mounting examples / Exemples de montage

